



City of Long Beach
 OUTLINE OF ACTIONS TOWARD THE
 DEVELOPMENT OF A LOCALLY PREFERRED STRATEGY FOR
 IMPROVING THE I-710 FREEWAY IN LONG BEACH

Adopted the following concepts for improving the I-710 Freeway for continued study based upon the City's Guiding Principles and the issues and concerns of the community:

1. Eliminate unnecessary truck ramps at the 91 Freeway interchange to minimize right-of-way impacts.
2. Utilize the space between the existing freeway and the Los Angeles River to add capacity and minimize right-of-way impacts.
3. Separate cars from trucks at-grade for increased safety wherever possible, and construct elevated structures only when necessary to minimize right-of-way impacts.
4. Modify existing freeway onramps and offramps to use "diamond" designs where possible to minimize right-of-way impacts and expand opportunities for green space.
5. Eliminate the Terminal Island Freeway extension to the I-710 Freeway.
6. Redesign the Showmaker Bridge and realign the ramps into downtown Long Beach to expand Cesar Chavez Park.

- █ AUTO & TRUCK MIXED FLOW
- █ TRUCK EXCLUSIVE LANE
- █ FREEWAY RAMP
- █ COLLECTOR, DISTRIBUTOR ROAD
- █ LOCAL STREET RECONSTRUCTION
- EXISTING RW LINE
- SOUND WALL

METRIC/ENGLISH UNIT CONVERSIONS
 1.0m = 3.0 ft
 2.4m = 8.0 ft
 3.0m = 10.0 ft
 3.6m = 12.0 ft

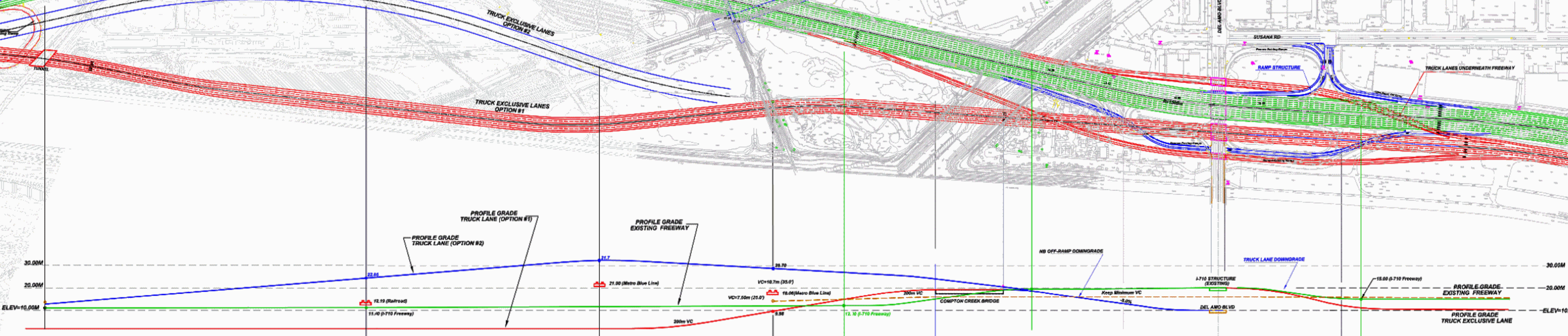


MARCH 18, 2004
 PLANS PREPARED BY:
Meyer, Mahaddes Associates, Inc.
 400 OCEANGATE, SUITE 400
 LONG BEACH, CA 90802-4307
 PHONE: (562)432-8484 FAX: (562)432-8485
 LEON D. WARD, P.E.

OPTION RR V2
OPTIONS 1 V3
OPTION 2 V4

DRAFT
CITY OF LONG BEACH
LOCALLY PREFERRED STRATEGY
I-710 FREEWAY